

Nursery gardens West Street Ryde, PO33 2DF

£325,000



CHAIN FREE!! This 3 bedrooms detached house is located in a quiet cul-de-sac location in the popular town of Ryde, within walking distance to local schools, Ryde town centre & ferry links to Portsmouth. The property consists of a dining room, downstairs shower room, fitted-kitchen, living room, two double bedrooms, one single bedroom & Family bathroom. Outside offers patio & garden area with decking to the rear. Other benefits of the property includes one off-road parking spaces, side access, gas central heating & double glazing. This is the perfect family home!!

CHAIN FREE!!

DETACHED

OFF-ROAD PARKING

3 BEDROOMS

CLOSE TO SCHOOLS, SHOPS & FERRY LINKS

GAS CENTRAL HEATING & DOUBLE GLAZING



# ROOMS

## Hallway

**Shower Room** 10' 10" x 2' 11" (3.3m x 0.9m)  
Laminate flooring. Walk-in shower & Sink. WC.

**Dining room** 9' 10" x 9' 10" (3m x 3m)  
Carpet. Double glazed window to front aspect.  
Radiator.

**Kitchen** 11' 2" x 9' 10" (3.4m x 3m)  
Vinyl flooring. Fitted-kitchen with wall base units. Gas hob & oven. Sink drainer. Boiler. Double glazed window to rear aspect & door leading on to garden.

## Under stairs storage

## Landing

Double glazed window to rear aspect.

**Bedroom 1** 12' 10" x 9' 10" (3.9m x 3m)  
Carpet flooring. Skylight window to front aspect.  
Radiator.

**Family Bathroom** 6' 3" x 6' 3" (1.9m x 1.9m)  
Laminate flooring. Bath with over head shower. Sink & WC. Heated towel rail. Skylight window to front aspect.

**Bedroom 2** 11' 2" x 11' 10" (3.4m x 3.6m)  
Carpet flooring. Skylight to front aspect. Radiator.

**Bedroom 3** 6' 11" x 9' 10" (2.1m x 3m)

GROUND FLOOR  
604 sq.ft. (56.1 sq.m.) approx.

1ST FLOOR  
400 sq.ft. (37.2 sq.m.) approx.

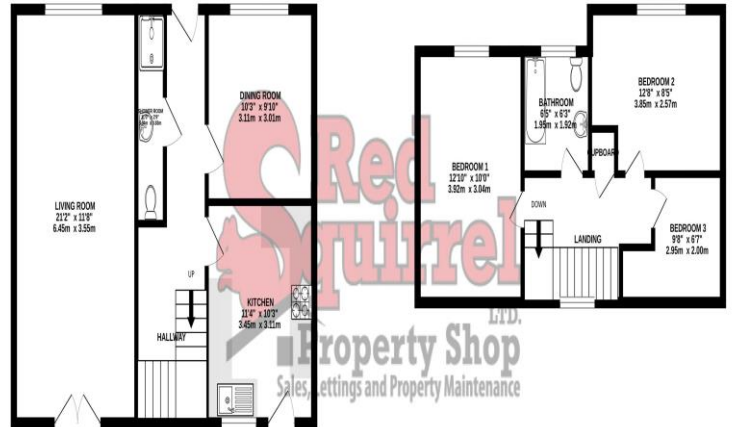

TOTAL FLOOR AREA: 1004 sq.ft. (93.3 sq.m.) approx.

While every attempt has been made to ensure the accuracy of the floorplan contained here, measurements of doors, windows, rooms and any other items are approximate and no responsibility is taken for any error, omission or mis-statement. This plan is for illustrative purposes only and should be used as such by any prospective purchaser. The services, systems and appliances shown have not been tested and no guarantee as to their operability or efficiency can be given.  
Made with Hectopix 12/2023



Address: 5 Nursery Gardens, West Street, RYDE, PO33 2DF  
RRN: 7034-4429-3300-0632-3206

